

SOUTHWEST EXECUTIVE CENTER

6214 PRESIDENTIAL COURT, UNIT C
FORT MYERS, FL 33919

Boback
Commercial
Group
Sales • Leasing • Property Management

UNIT C



FOR LEASE: \$10.00 PSF MODIFIED GROSS

ABOUT THE PROPERTY

This multi-unit condominium space is located within the College Parkway corridor and near the busy Summerlin Road area of professional and medical offices with easy access to all of Fort Myers and Cape Coral. Unit C consists of lobby, 4/5 offices, conference room, large open work area, one restroom and a kitchenette.

PROPERTY FEATURES

- Size: Unit C - 978± SF
- Zoning: CT - Commercial Tourist (Lee County)
- Move-In Ready
- Good Parking
- Traffic Count: College Pkwy - 37,500 AADT (2019)
Summerlin Rd - 32,900 AADT (2019)
- Property ID: 14-45-24-38.0000A.00E0

Many Possible Uses



Administrative Office • Financial Establishment
Business Services • Specialty Retail
Personal Services and more

JIM BOBACK, CCIM
Broker/Owner

C 239-565-2616 • O 239-466-7770
JB@BobackCommercialGroup.com
www.BobackCommercialGroup.com

SOUTHWEST EXECUTIVE CENTER

6214 PRESIDENTIAL COURT, UNIT C
FORT MYERS, FL 33919



Sales • Leasing • Property Management

UNIT C - 978± SF

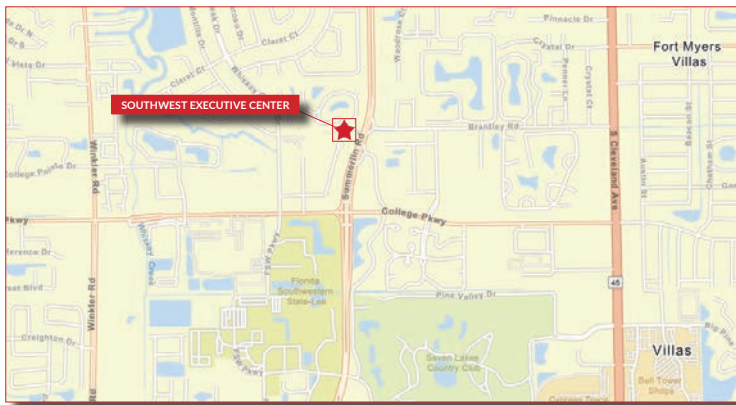
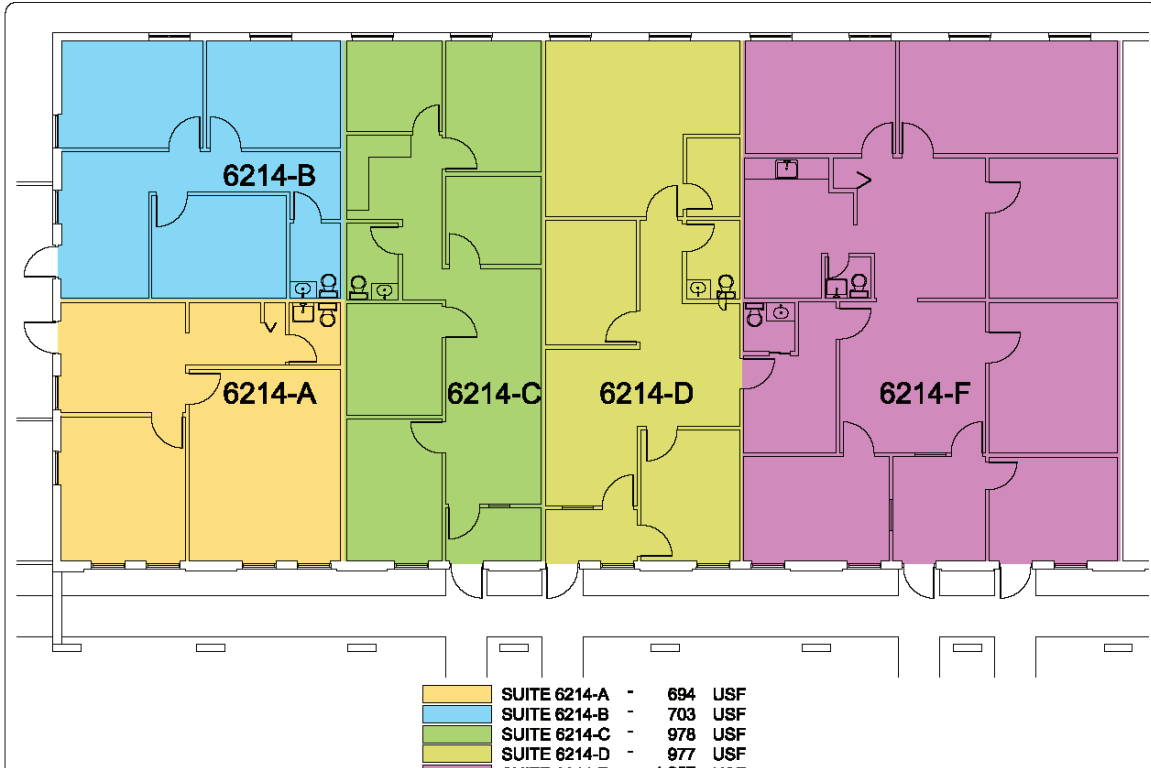

2020 DEMOGRAPHICS

	1 Mile	3 Miles	5 Miles
Population	12,904	64,426	153,387
# Households	6,537	31,009	70,919
Median HH Income	\$49,558	\$53,477	\$54,722
Median Age	49.3	49.3	50.8

JIM BOBACK, CCIM
Broker/Owner

C 239-565-2616 • O 239-466-7770
JB@BobackCommercialGroup.com
www.BobackCommercialGroup.com