

SOUTHWEST EXECUTIVE CENTER

6202 PRESIDENTIAL COURT, UNIT E
FORT MYERS, FL 33919

Boback
Commercial
Group
Sales • Leasing • Property Management



UNIT E

FOR LEASE: \$850.00/MONTH GROSS + TAX

ABOUT THE PROPERTY

This multi-unit condominium space is located within the College Parkway corridor and near the busy Summerlin Road area of professional and medical offices with easy access to all of Fort Myers and Cape Coral. Unit E consists of lobby with reception and an office area.

PROPERTY FEATURES

- Size: Unit E - 697± SF
- Zoning: CT - Commercial Tourist (Lee County)
- Move-In Ready
- Good Parking
- Traffic Count: College Pkwy - 28,900 AADT (2020)
Summerlin Rd - 26,200 AADT (2020)
- Property ID: 14-45-24-38.0000A.00E0

Many Possible Uses



Administrative Office • Financial Establishment
Business Services • Specialty Retail
Personal Services and more

JIM BOBACK, CCIM
Broker/Owner

C 239-565-2616 • O 239-466-7770
JB@BobackCommercialGroup.com
www.BobackCommercialGroup.com

SOUTHWEST EXECUTIVE CENTER

6202 PRESIDENTIAL COURT, UNIT E
FORT MYERS, FL 33919



Sales • Leasing • Property Management

UNIT E - 697± SF

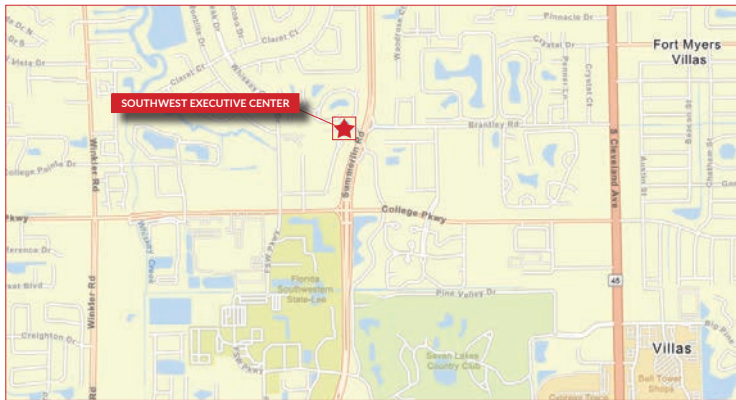
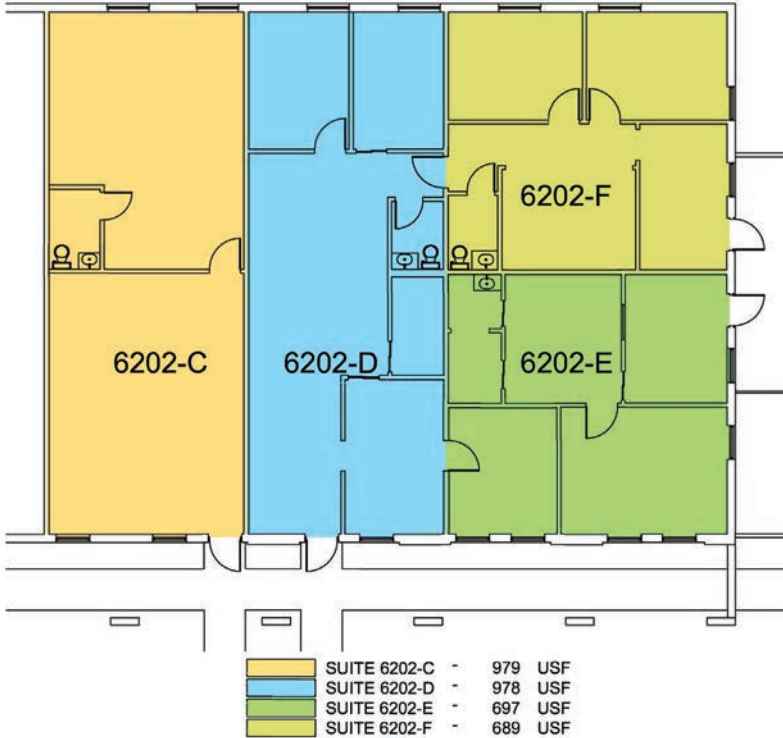

2021 DEMOGRAPHICS

	1 Mile	3 Miles	5 Miles
Population	13,200	65,225	156,170
# Households	6,712	31,482	72,405
Median HH Income	\$53,723	\$58,051	\$58,708
Median Age	51.1	50.2	51.4

JIM BOBACK, CCIM
Broker/Owner

C 239-565-2616 • O 239-466-7770
JB@BobackCommercialGroup.com
www.BobackCommercialGroup.com